



# Apilador Traccionario EP ES16-RS

Opcional con "Batería ION Litio"

- La estructura de alta resistencia se adapta a las estanterías y racks
- Dirección asistida y Sistema de accionamiento de posición lateral, fácil de gestionar de forma estable.
- Capacidad de Carga 1.600kg.
- Carga de oportunidad: enchufe y cargue en cualquier momento para continuar la operación.
- No requiere tiempo ni trabajo extra en el cambio de baterías

## ▣ CARACTERÍSTICAS Y VENTAJAS



### ■ TECNOLOGÍA AC CON SISTEMA DE CONTROL ZAPI

La tecnología AC con sistema de control ZAPI está bien adoptada por la industria.

### ■ DIRECCIÓN ASISTIDA ESTÁNDAR

La dirección asistida estándar permite que los operadores continúen trabajando durante largas horas.

### ■ OPCIÓN DE DESCENSO RÁPIDO PROPORCIONAL

La opción de descenso rápido proporcional está disponible para demandas de alta eficiencia.

### ■ SISTEMA DE TRANSMISIÓN DE POSICIÓN LATERAL

Hace su trabajo mucho más estable y fácil de manejar.

# Apilador Traccionario EP ES16-RS

Capacidad: 1600 kg.

Distinguishing mark				
1.1	Manufacturer			EP
1.2	Model designation			ES16-RS
1.3	Drive unit			Electric
1.4	Operator type			Standing
1.5	rated capacity	Q	kg	1600
1.6	Load center distance	c	mm	600
1.8	Load distance $\omega$ centre of drive axle to fork	x	mm	693
1.9	Wheelbase	y	mm	1375
Weight				
2.1	Service weight $\gamma$ include battery $\gamma$		kg	1240
2.2	Axle loading, laden driving side/loading side		kg	960/1880
2.3	Axle loading, unladen driving side/loading side		kg	860/380
Types,Chassis				
3.1	Tyre type Driving wheels/Loading wheels			PU/PU
3.2	Tyre size, driving wheels $\gamma$ diameter $\times$ width $\gamma$		mm	$\Phi$ 230 $\times$ 75
3.3	Tyre size, loading wheels $\gamma$ diameter $\times$ width $\gamma$		mm	$\Phi$ 85 $\times$ 70
3.4	Tyre size, caster wheels $\gamma$ diameter $\times$ width $\gamma$		mm	$\Phi$ 130 $\times$ 55
3.5	Wheels, number driving $\omega$ caster/loading (x=drive wheels)		mm	1x +1/4
3.6	Track width, front,driving side	b <sub>10</sub>	mm	574
3.7	Track width,rear,loading side	b <sub>11</sub>	mm	380/410/495
Dimensions				
4.2	Height, mast lowered	h <sub>1</sub>	mm	2020
4.3	Free lift	h <sub>2</sub>	mm	100
4.4	Lift height	h <sub>3</sub>	mm	2912
4.5	Height, mast extended	h <sub>4</sub>	mm	3465
4.9	Height drawbar in driving position min./max.	h <sub>14</sub>	mm	1150/1480
4.15	Lowered height	h <sub>13</sub>	mm	88
4.19	Overall length	l <sub>1</sub>	mm	2030
4.20	Length to face of forks	l <sub>2</sub>	mm	879
4.21	Overall width	b <sub>1</sub>	mm	850
4.22	Fork dimensions	s/ e/ l	mm	60 $\times$ 190 $\times$ 1150
4.24	Fork carriage width	b <sub>3</sub>	mm	800
4.25	Outside width of the forks	b <sub>5</sub>	mm	570/600/685
4.32	Ground clearance, center of wheelbase	m <sub>2</sub>	mm	28
4.34.1	Aisle width for pallets 1000 $\times$ 1200 crossways	Ast	mm	2605/2965
4.34.2	Aisle width for pallets 800 $\times$ 1200 lengthways	Ast	mm	2575/2935
4.35	Turning radius	Wa	mm	1730/2090
Performance data				
5.1	Travel speed, laden/ unladen		km/ h	5.5/6.0
5.2	Lifting speed, laden/ unladen		m/ s	0.13/0.16
5.3	Lowering speed, laden/ unladen		m/ s	0.30/0.22
5.8	Max. gradeability, laden/unladen		%	8/16
5.10	Service brake type			Electromagnetic
Electric-engine				
6.1	Drive motor rating S2 60 min		kW	1.6
6.2	Lift motor rating at S3 15%		kW	3.0
6.3	The maximum allowed size battery		mm	834 $\times$ 216 $\times$ 630
6.4	Battery voltage/nominal capacity K5		V/ Ah	24/210
6.5	Battery weight		kg	200
Addition data				
8.1	Type of drive unit			AC
10.5	Steering type			Electronic
10.7	Sound pressure level at the driver's ear		dB (A)	74

If there are improvements of technical parameters or configurations, no further notice will be given.  
The diagram shown may contain non-standard configurations.

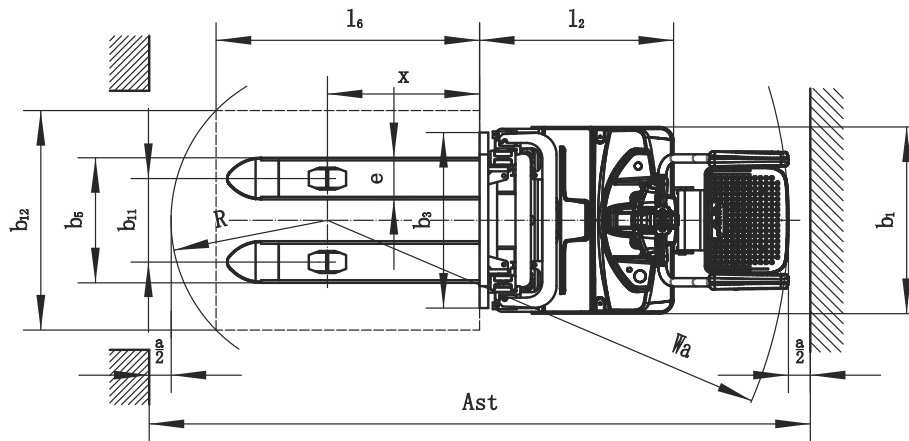
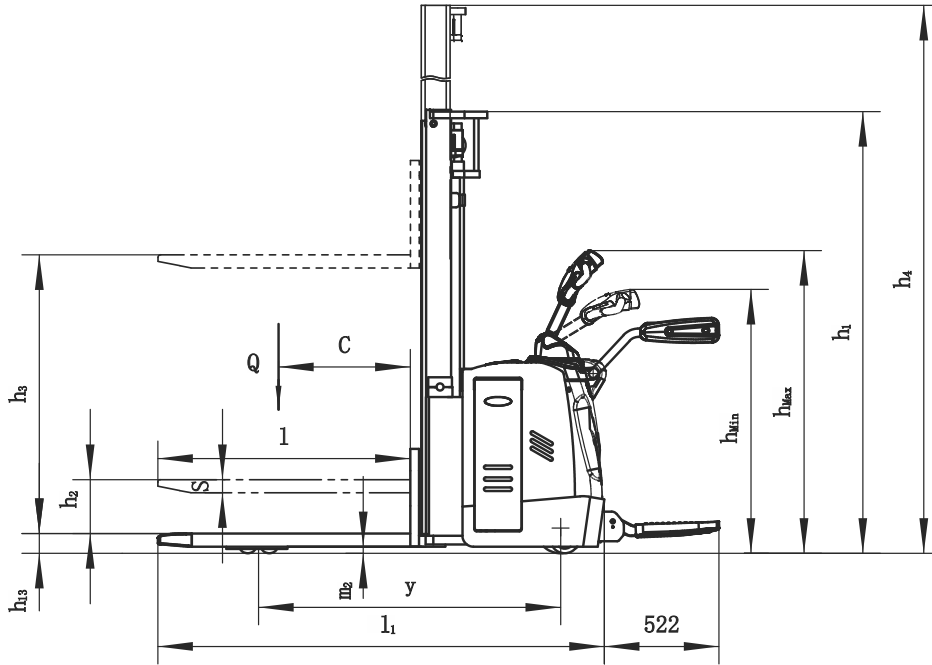

### RATED CAPACITIES GRAPH

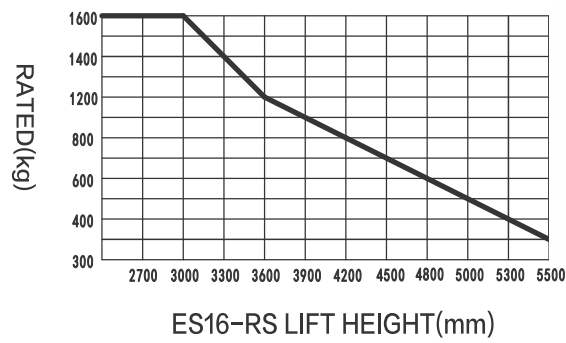

## Opciones de Mástiles

Lift h3+h13 □ mm □	mast types	Lowered mast height h1 □ mm □	Free lift h2 □ mm □	Extended mast height h4 □ mm □
2700	Duplex ZT	1870	100	3165
3000		2020	100	3465
3300		2170	100	3765
3600		2320	100	4065
3900		2470	100	4365
4170		2600	100	4625
4000	Triplex DZ	1822	1390	4460
4500		2022	1590	4960
4800		2122	1690	5260
5000		2187	1740	5460
5300		2287	1840	5760
5500		2352	1910	5910
2700	Duplex ZZ	1819	1320	3135
3000		1969	1470	3435
3300		2119	1620	3735

## Opcionales de equipamiento

Options		ES16-RS
3	Fork length	↑ 1150  1220
4	Fork width	↑ 570  600/685
10	Driving wheel	↑ PU  Rubber wheel/PU wheel with Pattern
11	Balance wheel	↑
15	cold storage	↑
16	Mast screen	↑
17	Battery indicator with hour meter	↑
18	Battery indicator without hour meter	↑
19	Battery capacity	↑ 210AH  230AH/280AH
20	Lateral change battery	↑
22	Water auto-filling system	↑
25	Vertical handler working	—
26	Proportional lifting	↑
27	Height limitation	↑
30	Side shift	—
31	half speed function in turning	↑
32	Guard arm	↑

Note: ● standard ○ option — NA